

NOTE: THE POTOMAC LOUVER BLADE IS A PROPRIETARY DESIGN BY HERCULES.

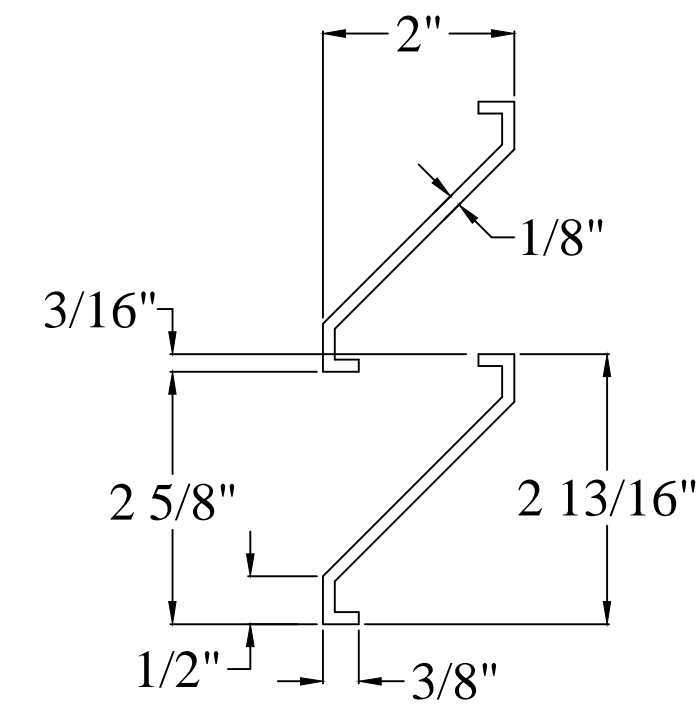

SECTION

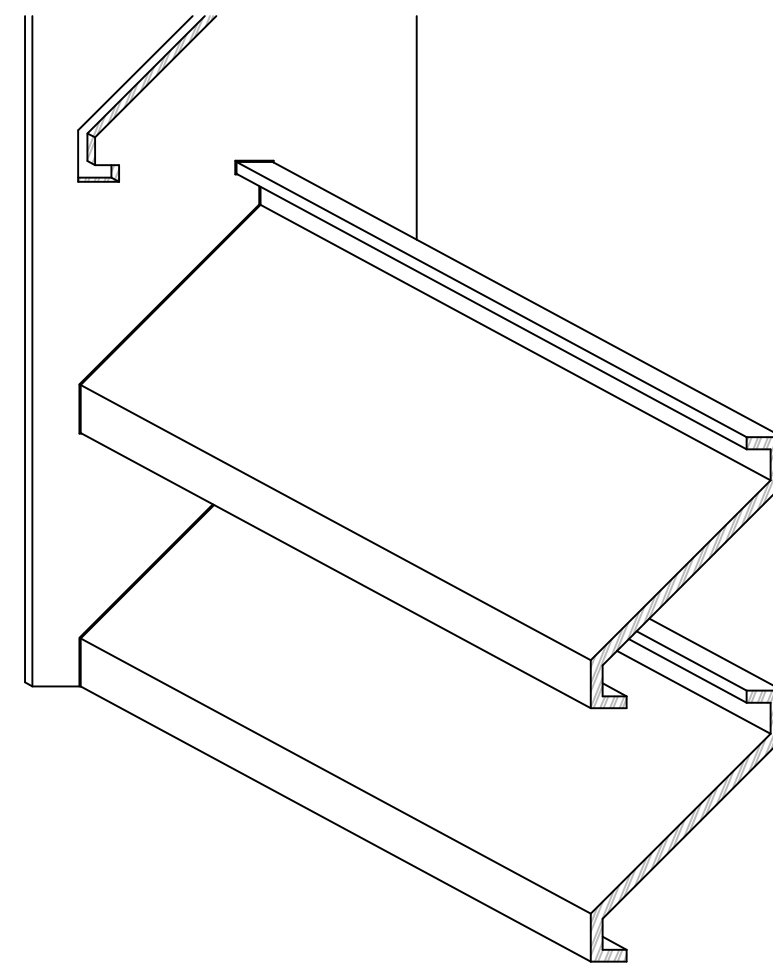

3D IMAGE

POTOMAC LOUVER BLADE DETAIL

6"=1'-0"

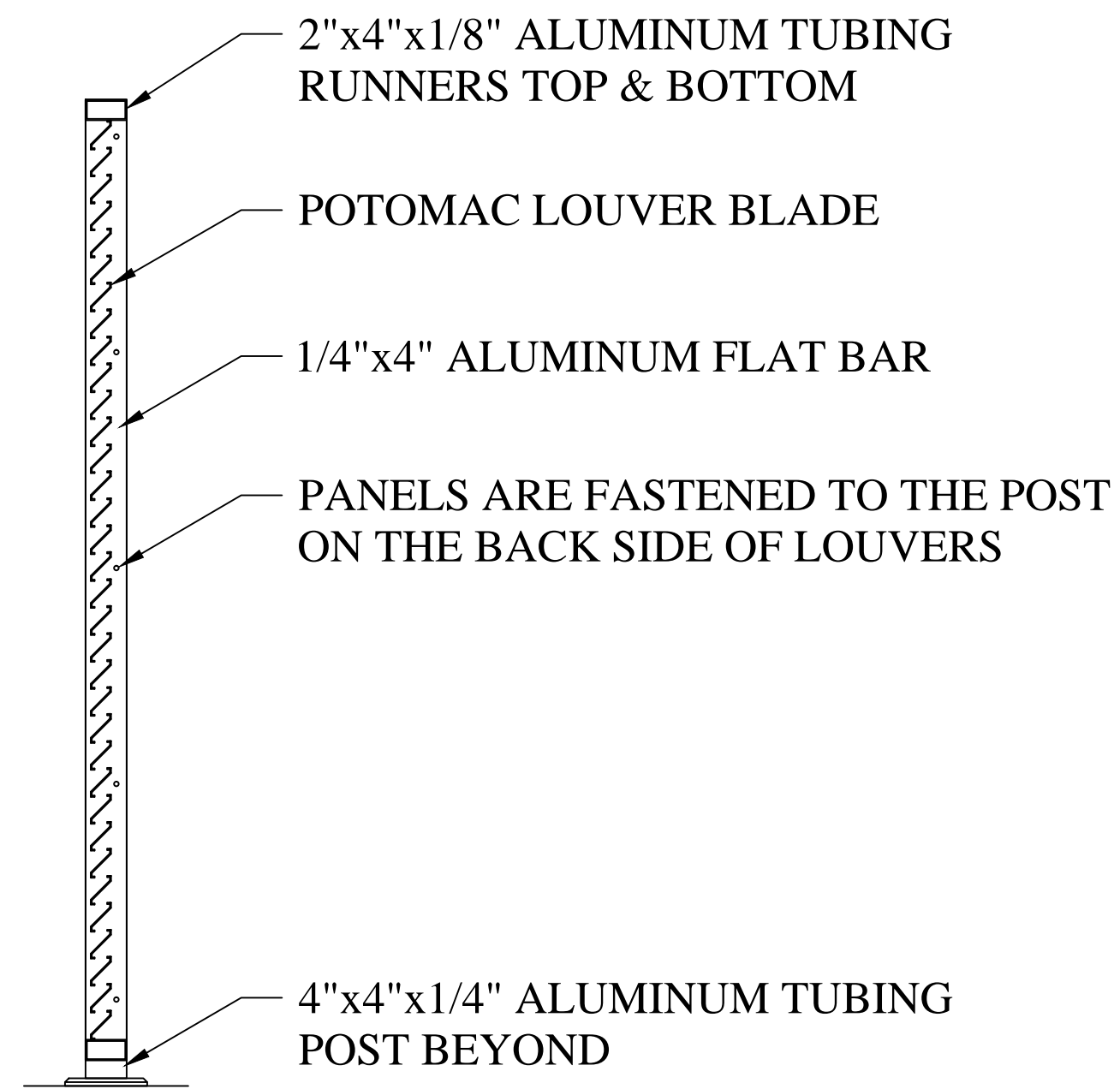

SECTION A-A

3/4"=1'-0"

NOTES:

MEASUREMENTS ARE SITE VERIFIED PRIOR TO PRODUCING BUILD DRAWINGS FOR FABRICATION.

LOUVERED SYSTEM RECEIVES A POWDER COATED FINISH AFTER FABRICATION CHOSEN FROM OUR STANDARD RAL COLORS.

PANELS ARE MECHANICALLY FASTENED TO THE POSTS WITH STAINLESS STEEL #14x1 1/4" SELF-TAPPING SCREWS.

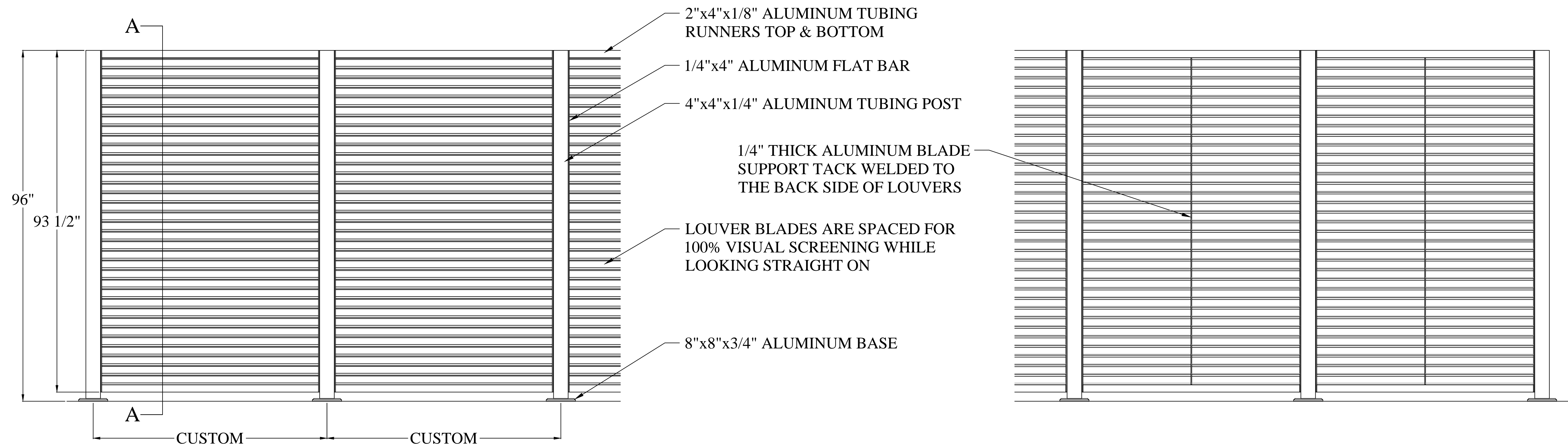

EXTERIOR ELEVATION

INTERIOR ELEVATION

DOUBLE GATE ELEVATION

3/4"=1'-0"

8' HEIGHT SHOWN (CUSTOM HEIGHTS AVAILABLE)

POTOMAC LOUVER
PANEL DETAILS

Revisions

HERCULES CUSTOM IRON, LLC
AN AFFILIATE OF HERCULES FENCE
36 W. PENNSYLVANIA AVENUE
WALKERSVILLE, MD 21793
1-800-331-2590

A2
SHEET NO.

Drawn by: D.L.M.
Date: 7-8-2015
Scale: 3/4"=1'-0"

